

Dorval International Montreal Airport Canada, 1994 and up



Basra Int.l Airport - Iraq 2003



New Herat Int'l Airport - Master Plan *Landside Development*

Landside development is comprehensive of:

- Access road and car park
- Passengers terminal
- Cargo area
- General aviation facilities
- Ancillary buildings
- Business district
- Airline base facilities
- Utilities

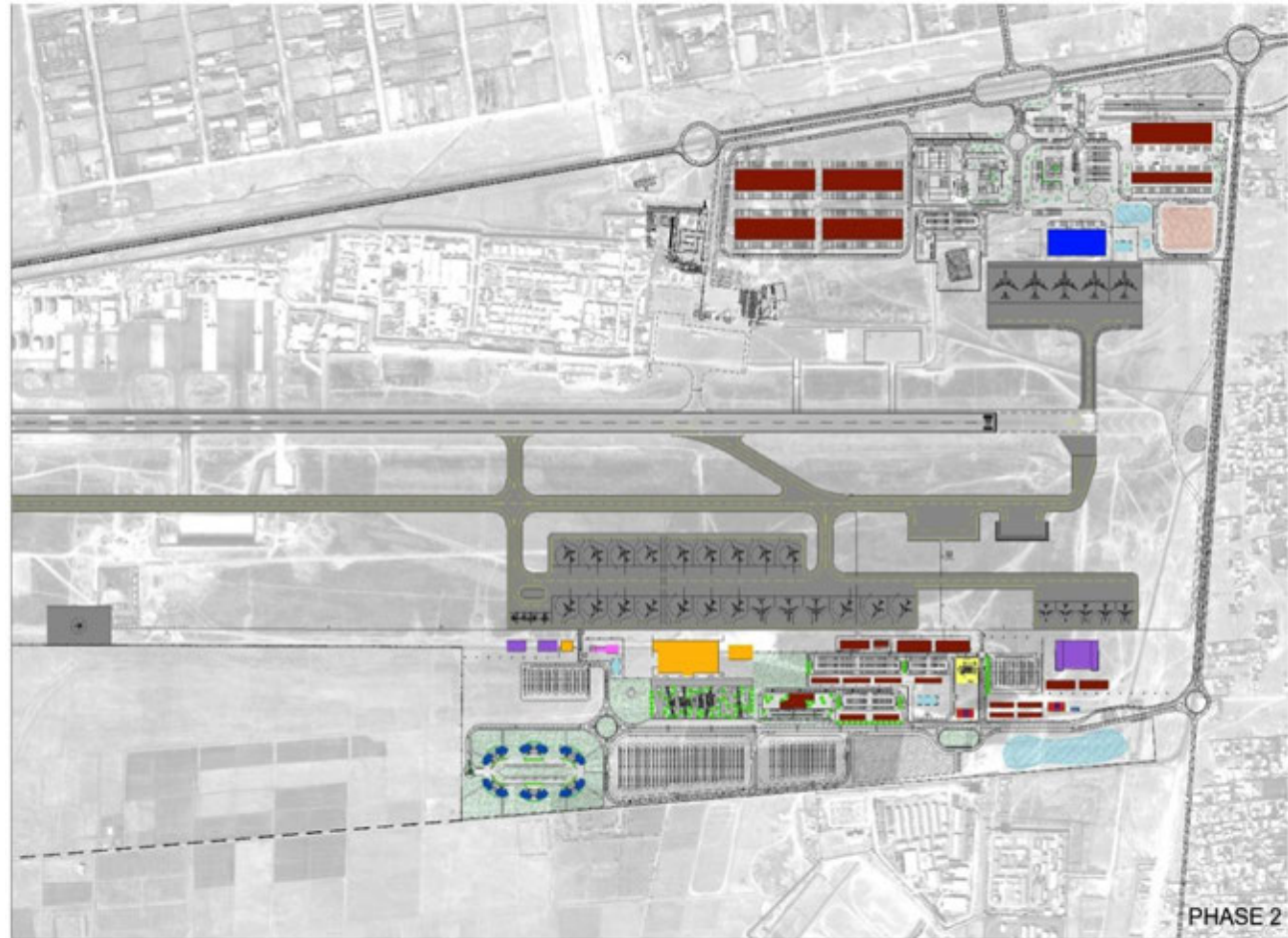

Herat Freight Int.l Airport - Master Plan

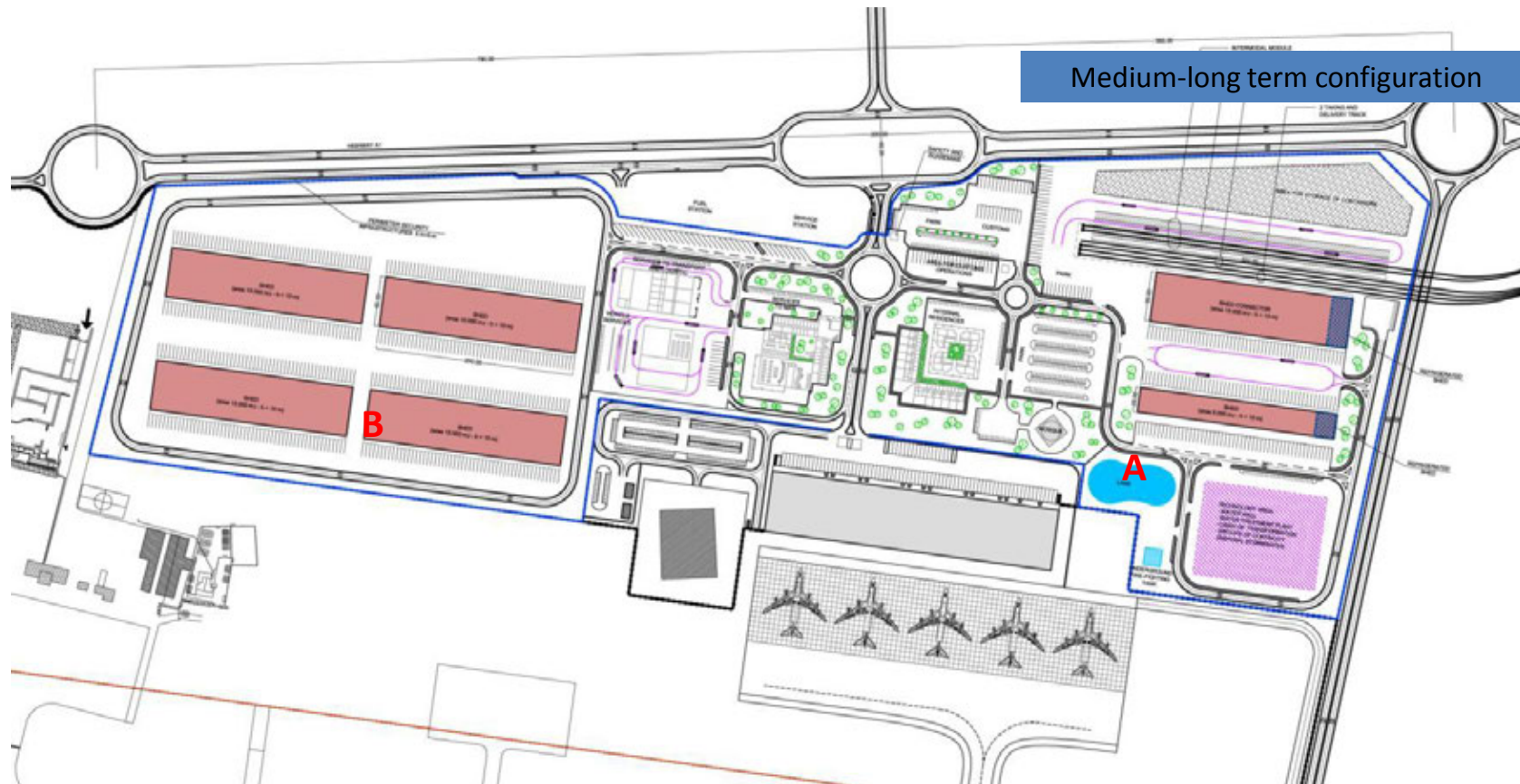

NEW HERAT INTERNATIONAL AIRPORT

New Herat Int'l Airport Terminal Complex

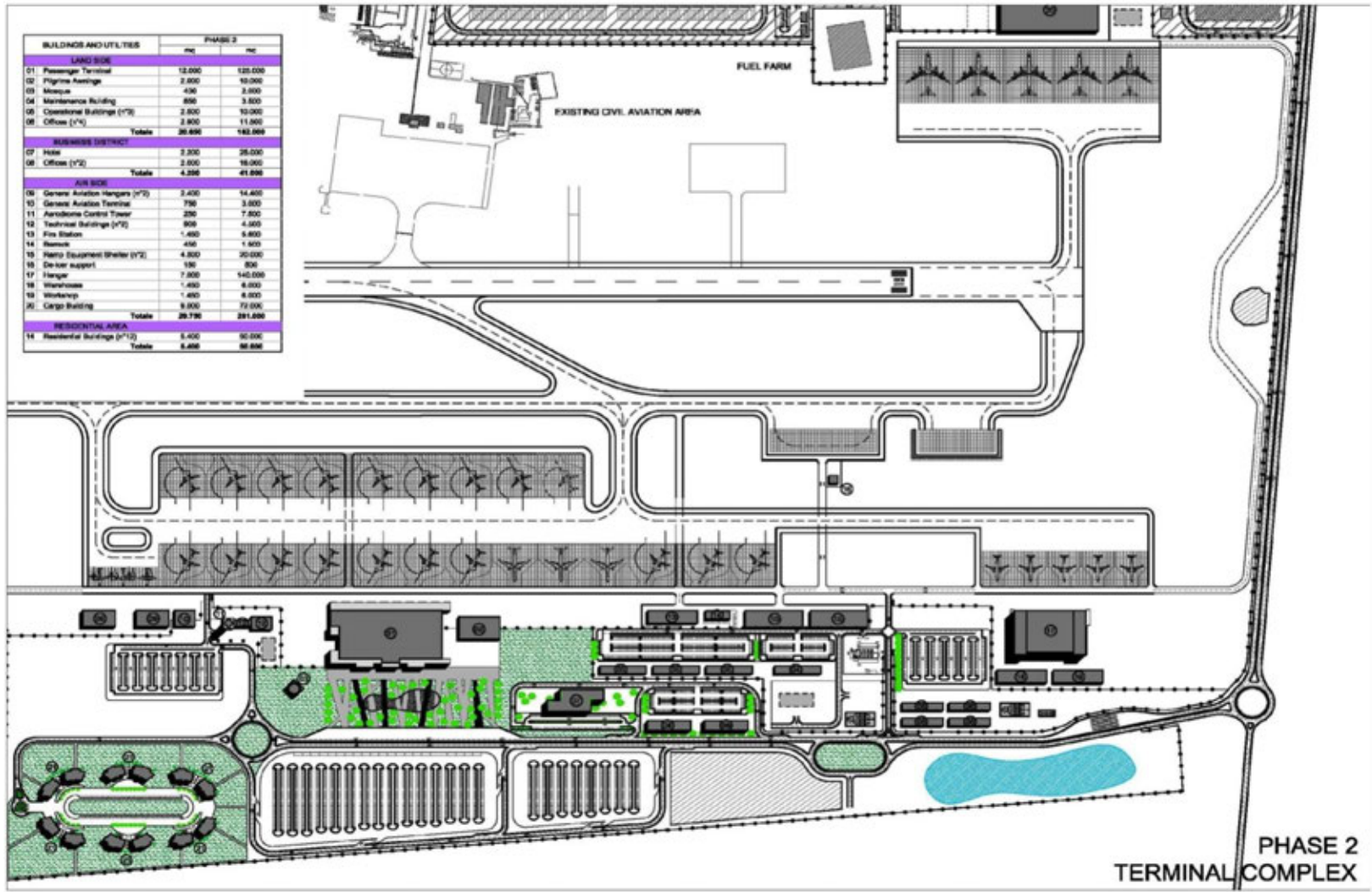

PHASE 2
TERMINAL COMPLEX

Verona Int.l Airport

Civil and Military airport

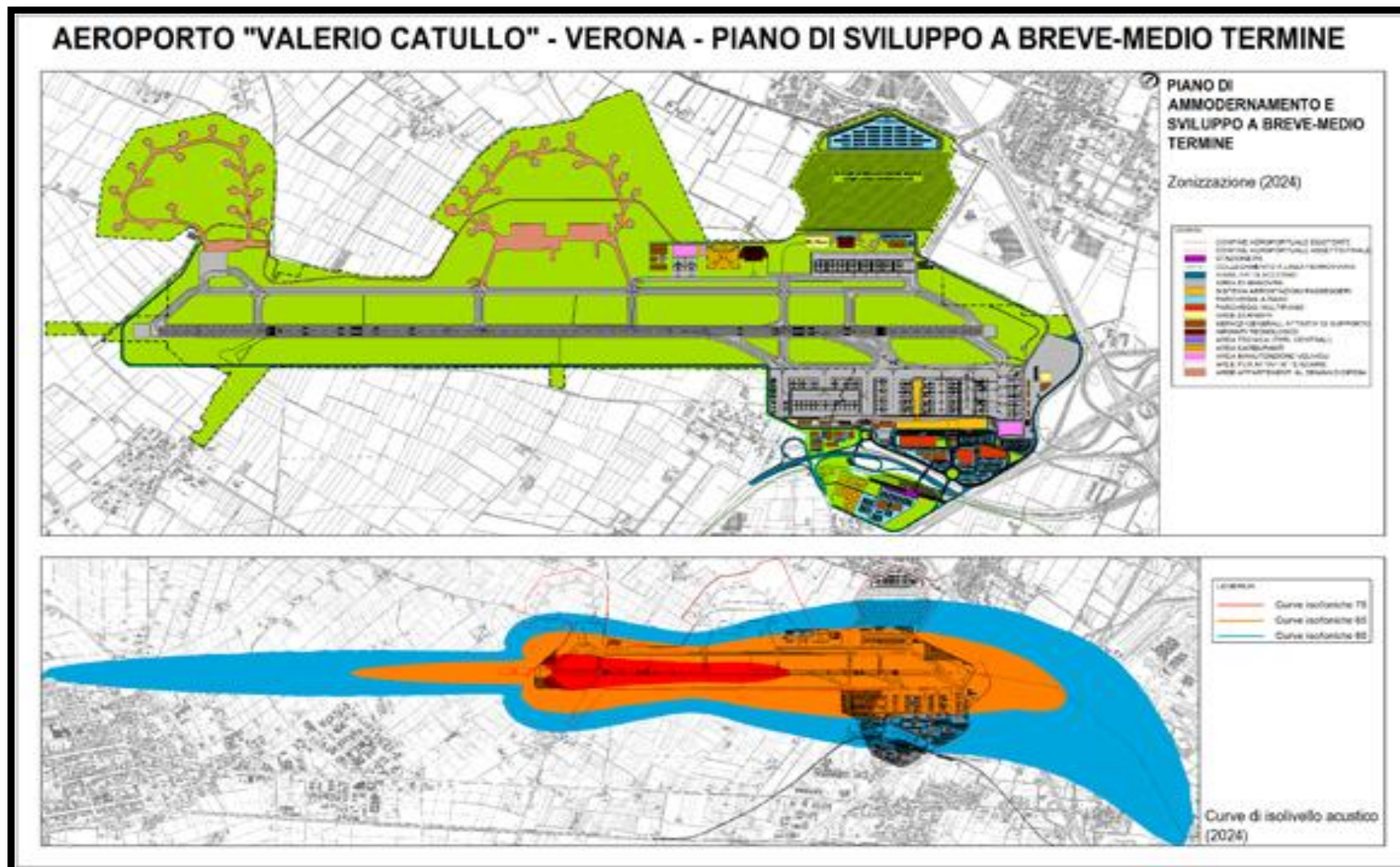

Verona Int.I Airport

AEROPORTO "VALERIO CATULLO" - VERONA - PREVISIONI DI TRAFFICO AEREO

SEGMENTO NAZIONALE



MOVIMENTI AEROMOBILI "BUSY DAY" (high season) - PREVISIONE 2007-2024

anno	2007	2008	2009	2010	2011	2012	2013	2014	2015	2016	2017	2018	2019	2020	2021	2022	2023	2024
Business	15,000	15,200	15,500	15,800	16,000	16,200	16,500	16,800	17,000	17,200	17,500	17,800	18,000	18,200	18,500	18,800	19,000	19,200
Other	20,000	20,500	21,000	21,500	22,000	22,500	23,000	23,500	24,000	24,500	25,000	25,500	26,000	26,500	27,000	27,500	28,000	28,500
Low Cost	100	100	100	100	100	100	100	100	100	100	100	100	100	100	100	100	100	100
Total	35,100	35,800	36,600	37,400	38,100	38,800	39,500	40,300	41,000	41,700	42,500	43,300	44,000	44,700	45,500	46,300	47,000	47,700
Business Busy Day	100	100	100	100	100	100	100	100	100	100	100	100	100	100	100	100	100	100
Low Cost Busy Day	10	10	10	10	10	10	10	10	10	10	10	10	10	10	10	10	10	10

SEGMENTO INTERNAZIONALE

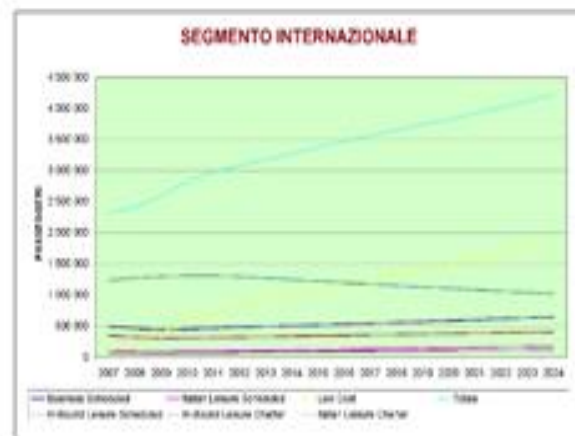

Verona Int.I Airport

AMS Operation Room



Brescia  Aeroporto
Garda Aeroporti



Verona Airport

AMS (Apron Management Service) – Project, training and realization.

June-September 2008

ENAC Certificate

NEW MULTILEVEL PARKING

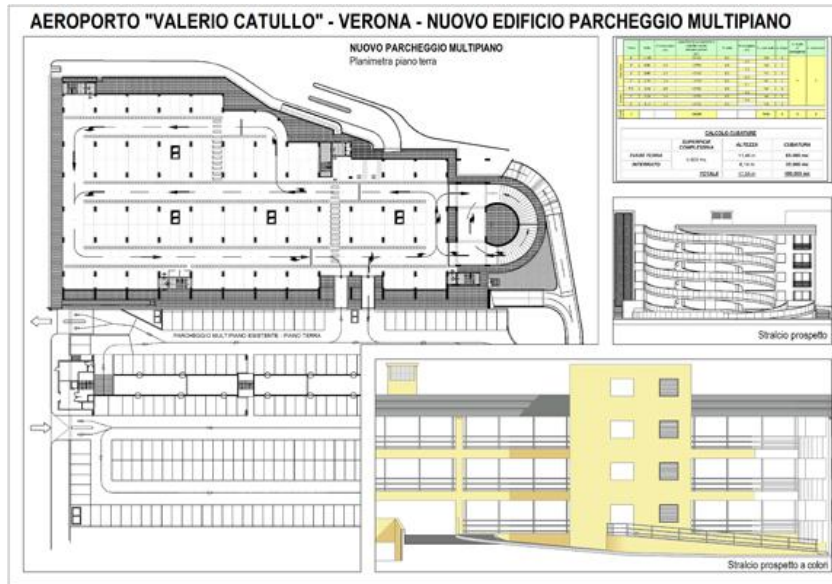

AEROPORTO "VALERIO CATULLO" - VERONA - NUOVA AEROSTAZIONE PARTENZE



AEROPORTO "VALERIO CATULLO" - VERONA - NUOVE PENSILINE AEROSTAZIONE ARRIVI



NEW DEPARTURE TERMINAL

Brescia Airport - Master Plan

Medium Term

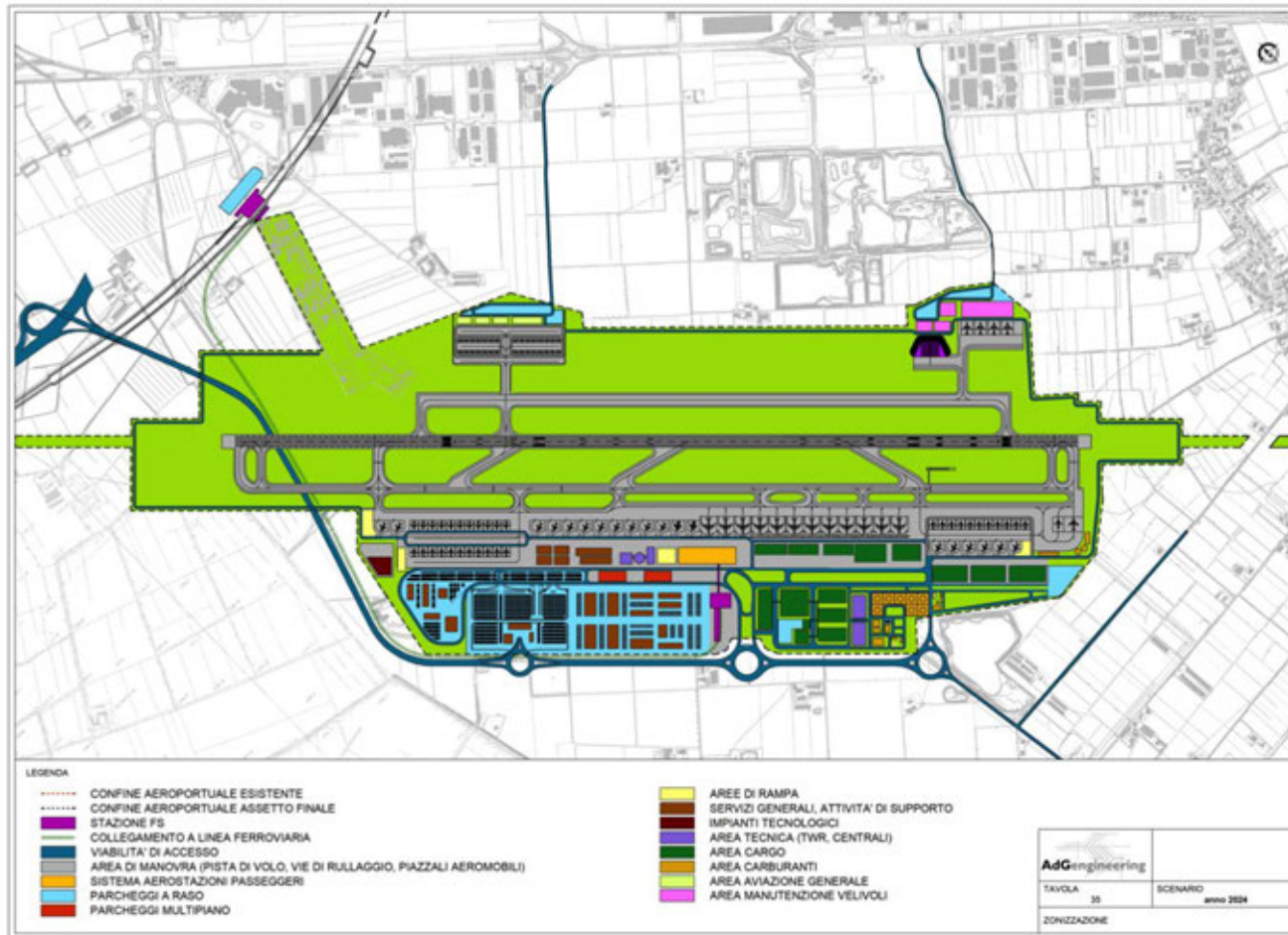

Brescia Airport - Master Plan

Long Term

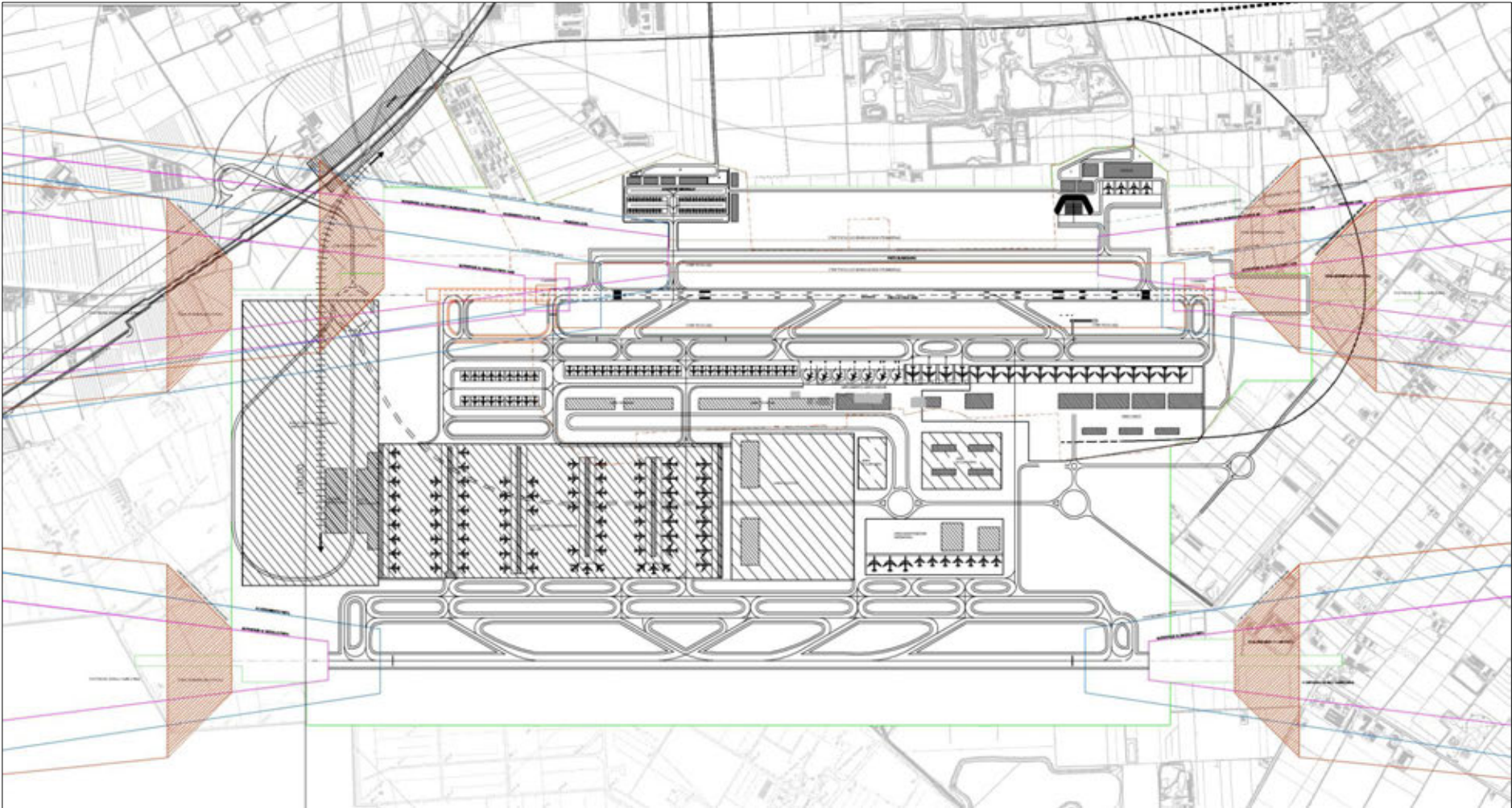

Brescia Airport

NEW CARGO AREA

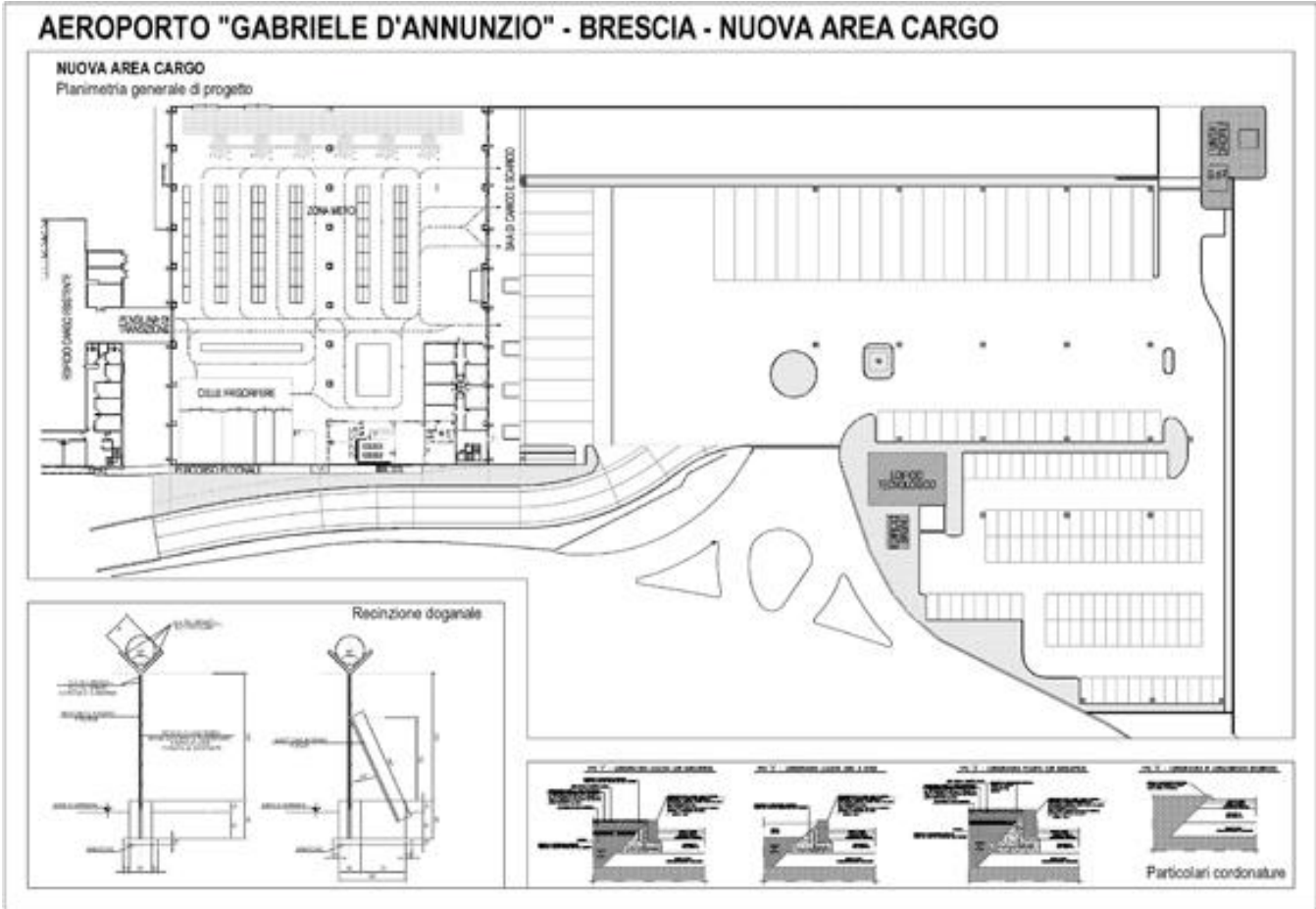

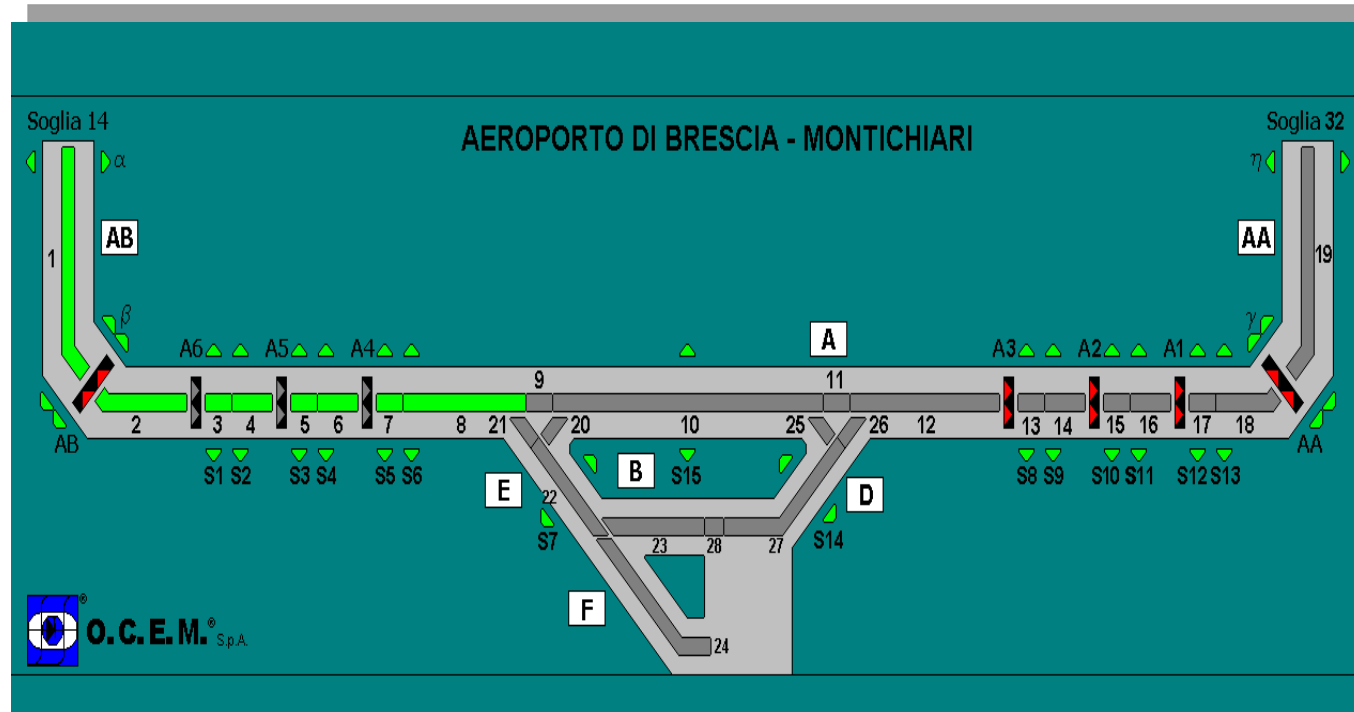

Study and realization of an innovative system “Follow the Green Lights”, finalized to give automatic lights informations to the Pilots when in low visibility conditions (with InfraRed system).

NEW APRON STANDS

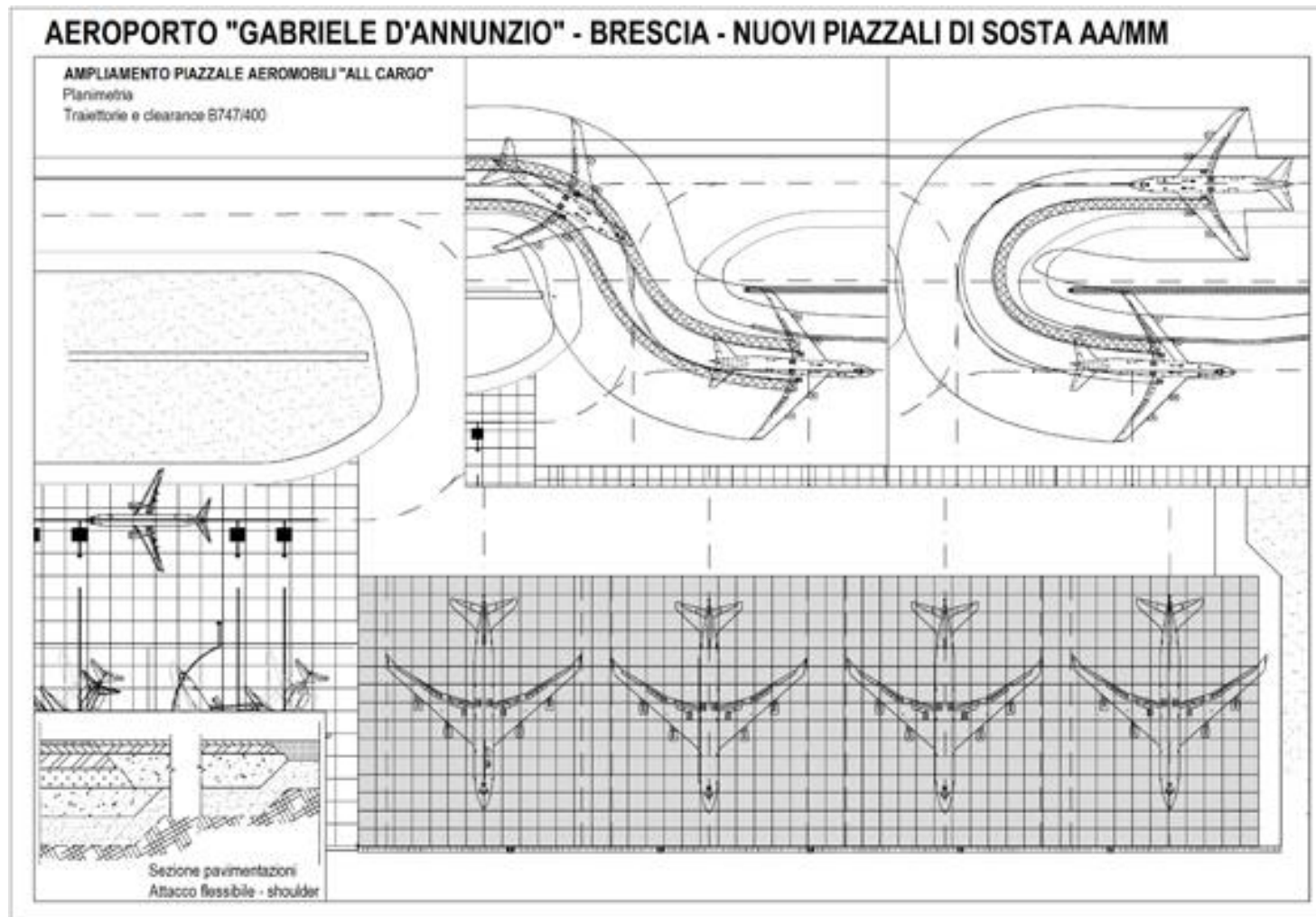

VLA PLANT : ADJUSTING AND STRENGTHENING

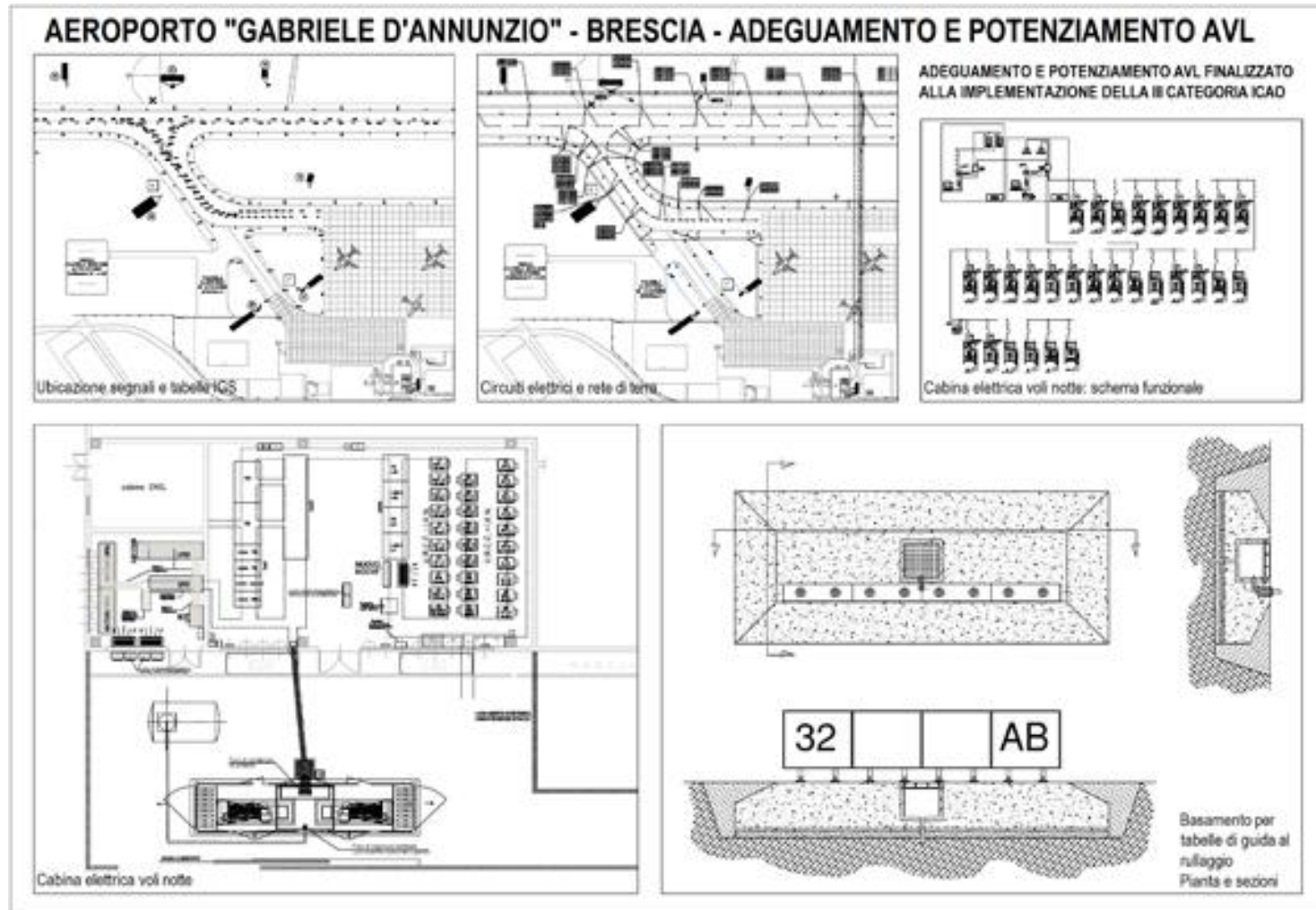

Genoa Airport



AIR TERMINAL BUILDING REMODELLING AND REFURBISHMENT

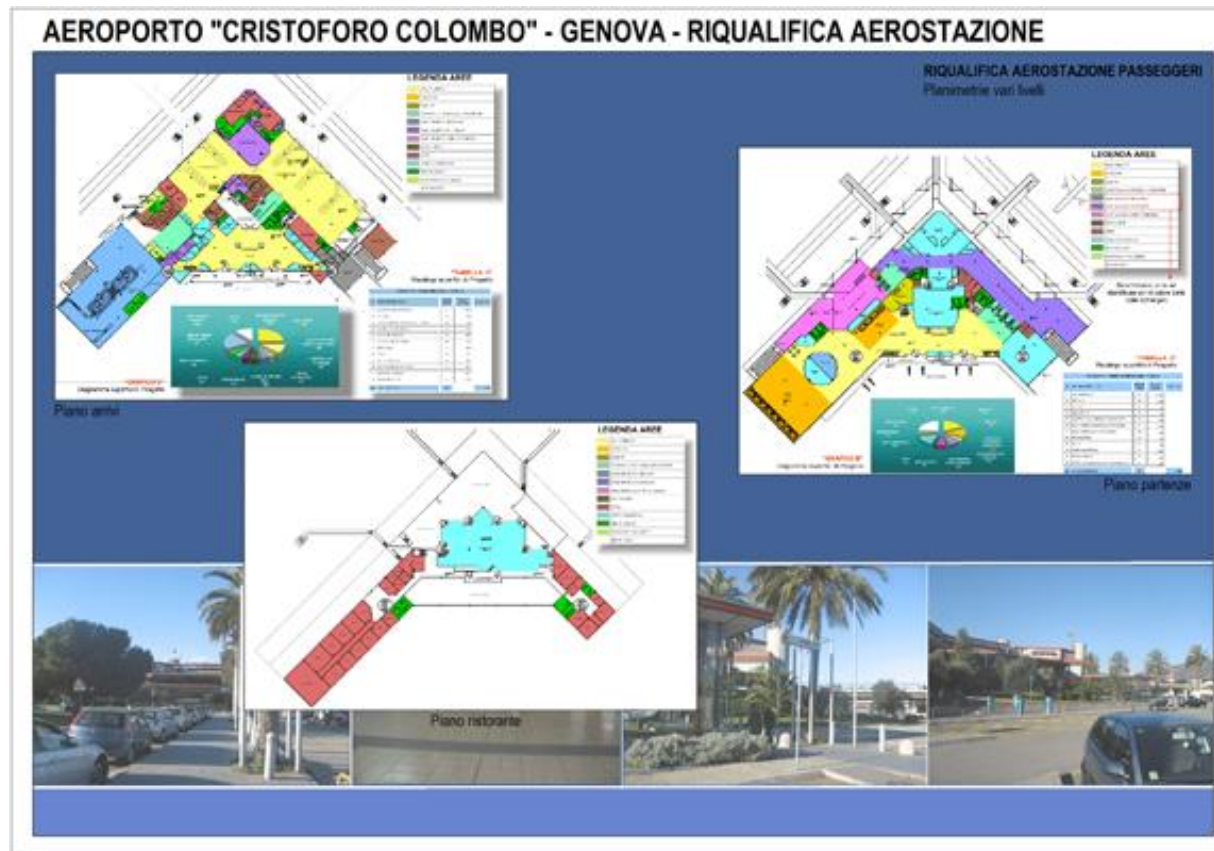

Genoa Airport

NEW TAXIWAY LINK



AEROPORTO "CRISTOFORO COLOMBO" - GENOVA - NUOVA BRETELLA DI RACCORDO

NUOVA BRETELLA DI RACCORDO FRA IL VIADOTTO DI ACCESSO PRINCIPALE AL SEDIME AEROPORTUALE E LA VIABILITA' DI COLLEGAMENTO AL PORTO TURISTICO
Pianta delle lavorazioni

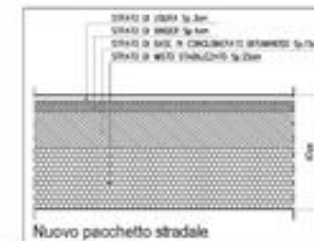
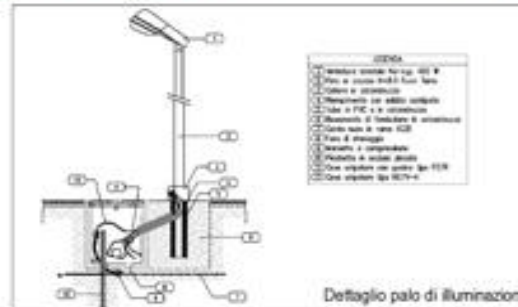
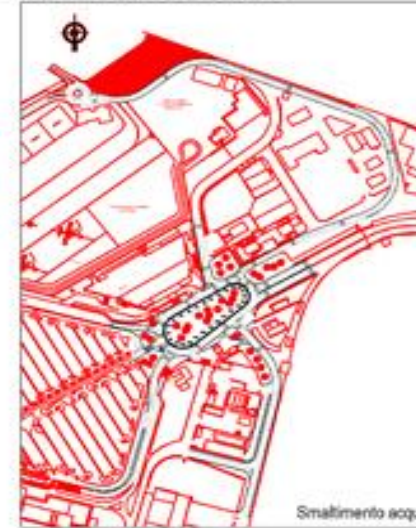

Milano Malpensa – New ATC Control Tower

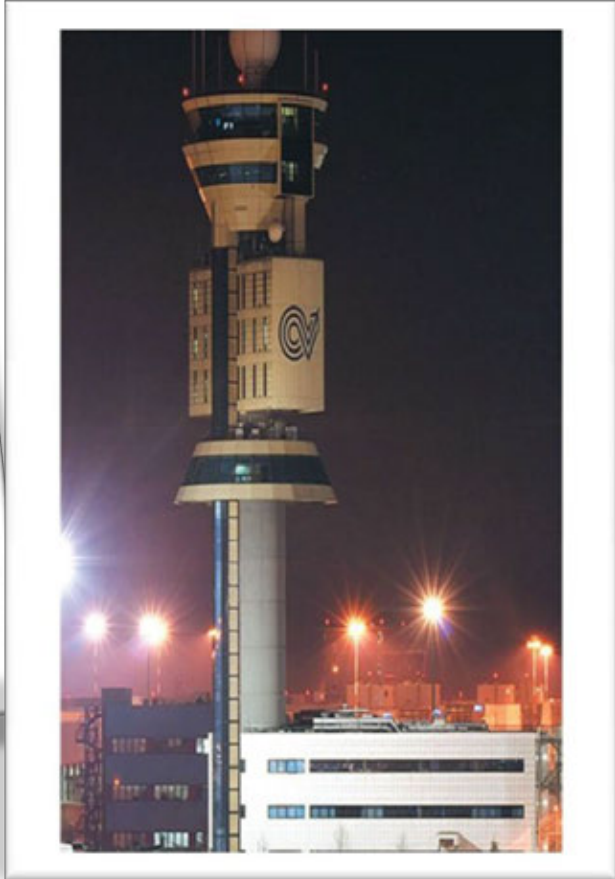

**New ATC Control Tower Opening
Oct. 31, 1999
A-SMGCS Implementation**

Rome Fiumicino
Air Traffic Improvement
Airport Capacity Project

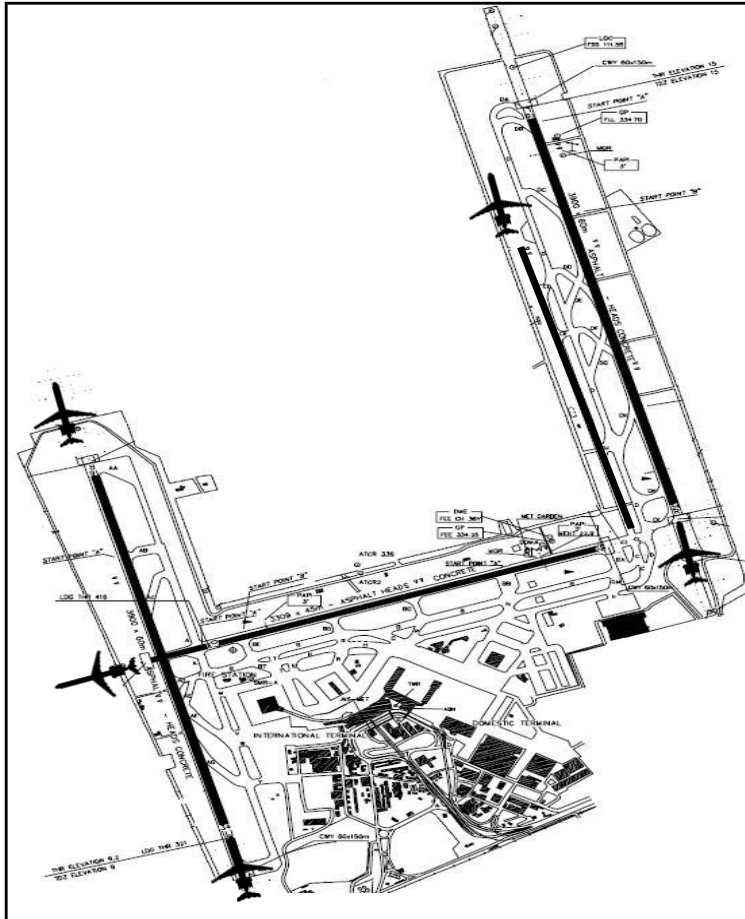

Rome Fiumicino – Short Term Development Plan : new 4 th Runway Project (16C-34C).

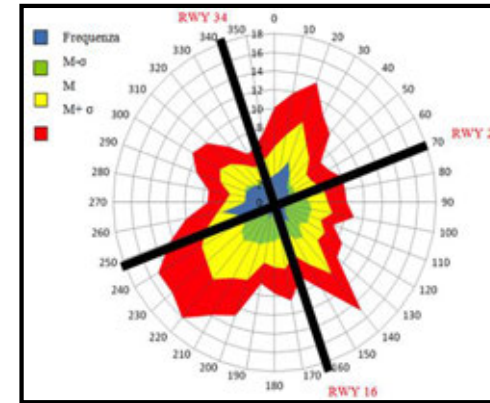

Meteorological Analysis (wind diagram)

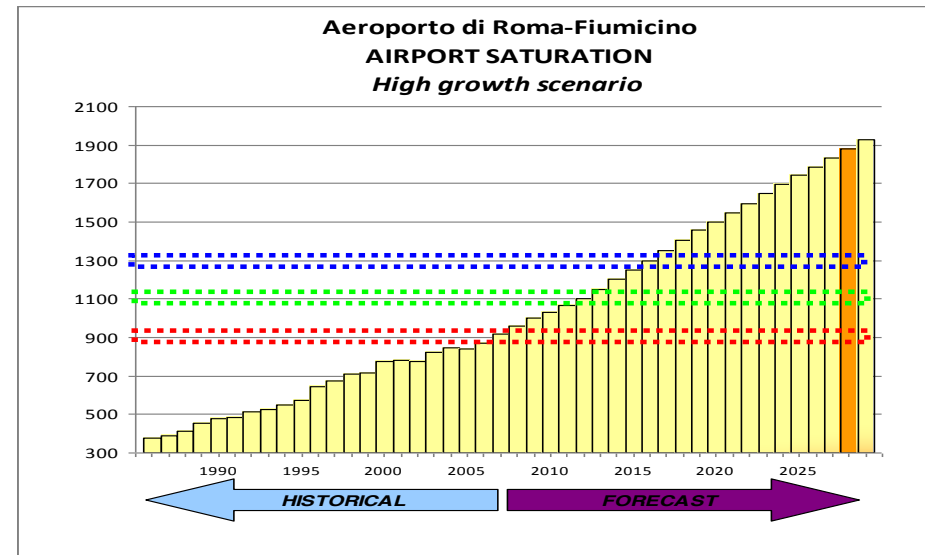

Airport Analysis for expected increasing Traffic

Identify Airport Noise Compatibility and New Departure Routing

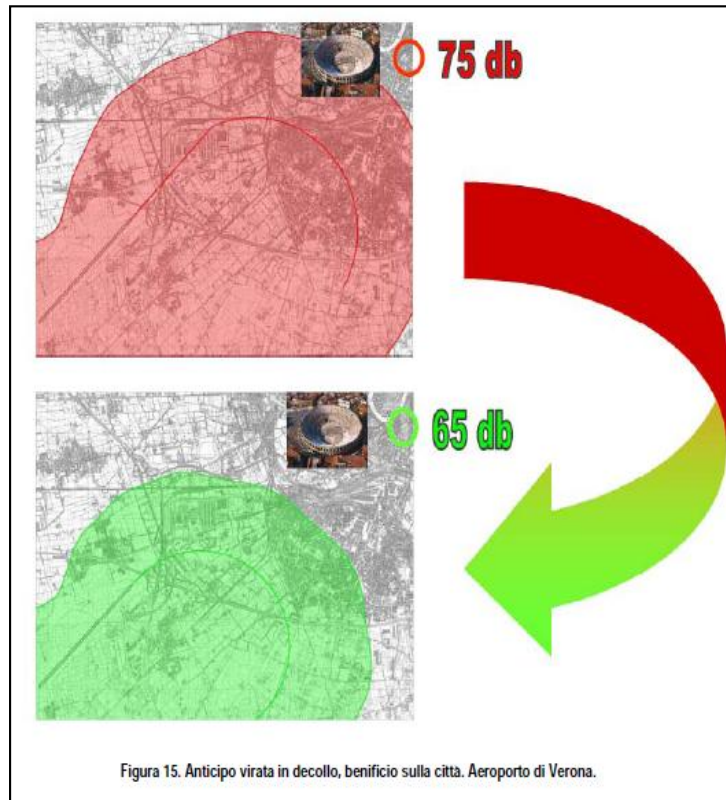

INM 6.0 software utilization to new flight procedures –
airport Noise footprint.

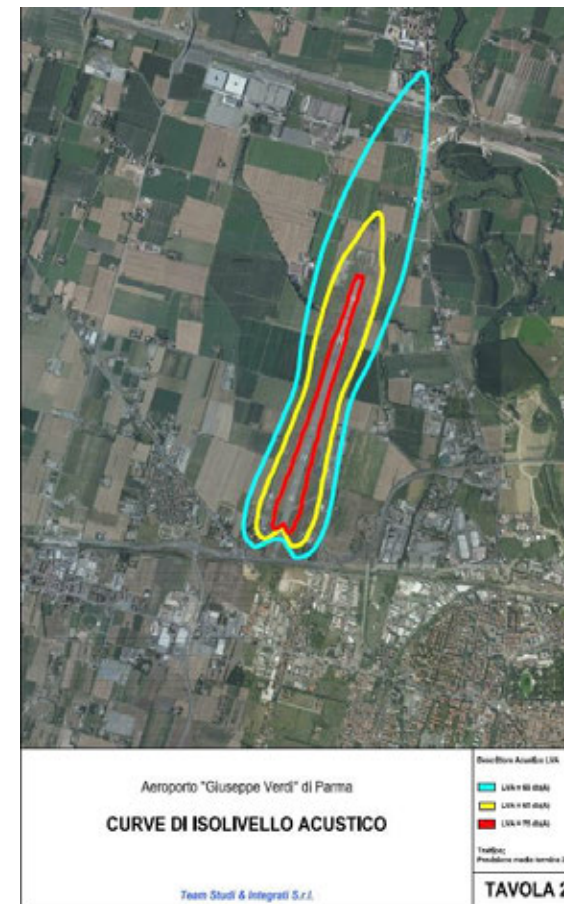

Bologna Airport



Automatic Vehicles Monitoring

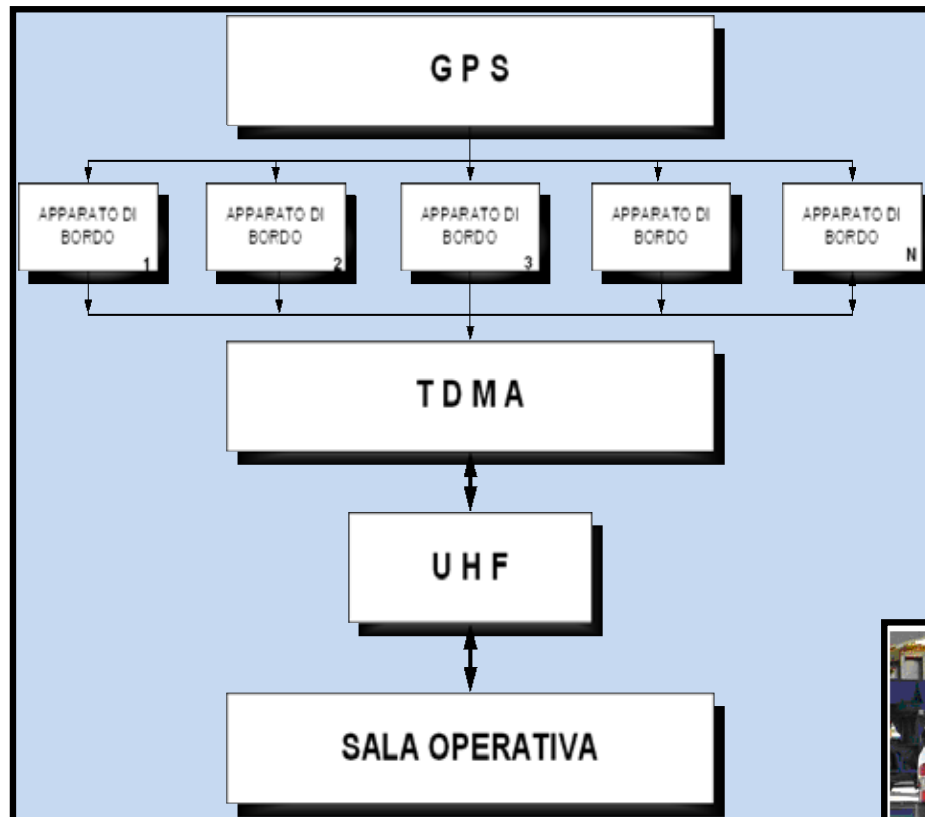

Rimini Airport



Study and realization of:

- ▶ Apron Management Service (AMS)
- ▶ Safety Management Service (SMS)
- ▶ Airside Driving Licence (ADC)
- ▶ Vertical / Horizontal Signs
- ▶ Airport Emergency Plan
- ▶ Bird Strike
- ▶ Airport Staff Training



Rimini Airport - New AVL System

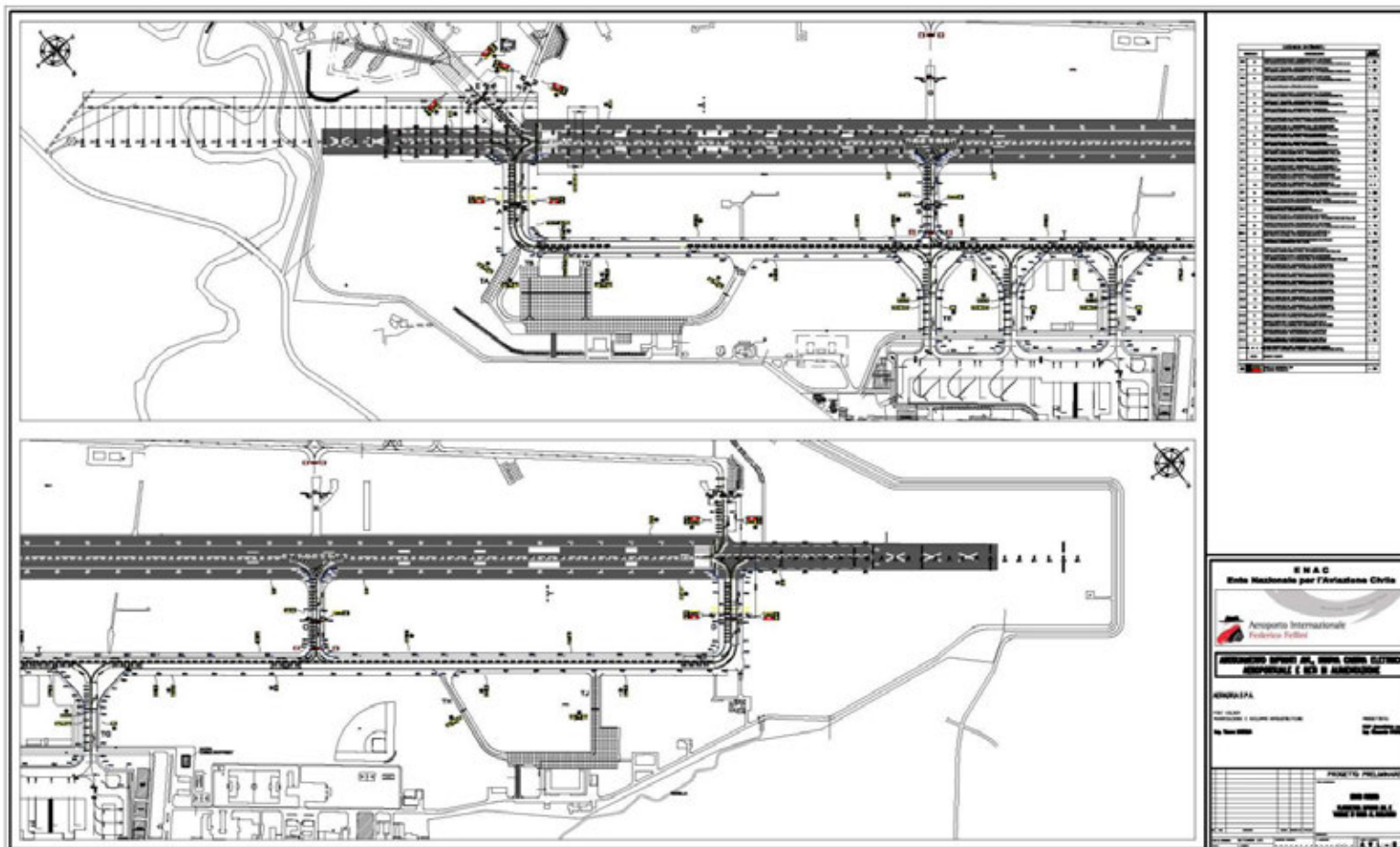

Rimini Airport

New Apron Lay-out and road system

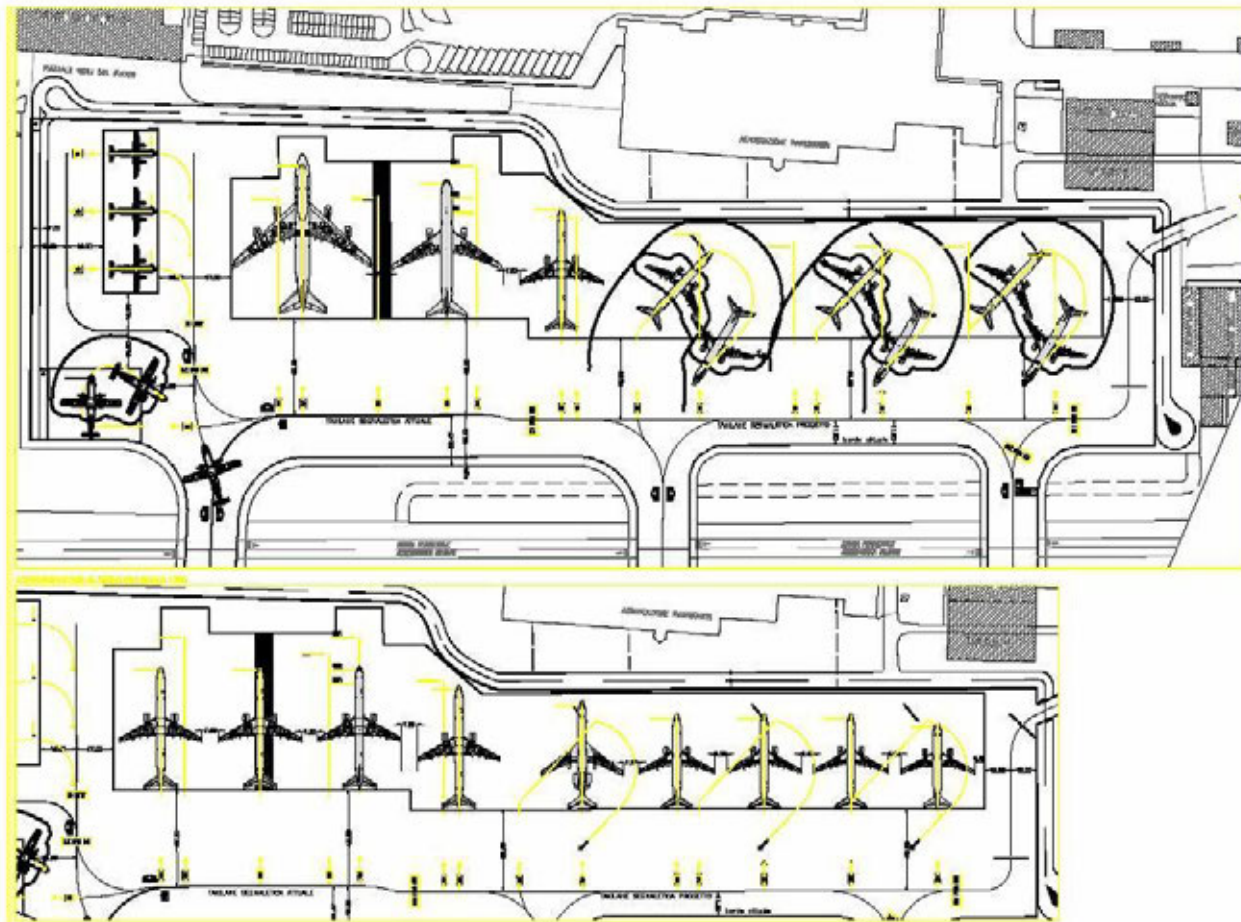

Johannesburg International Airport

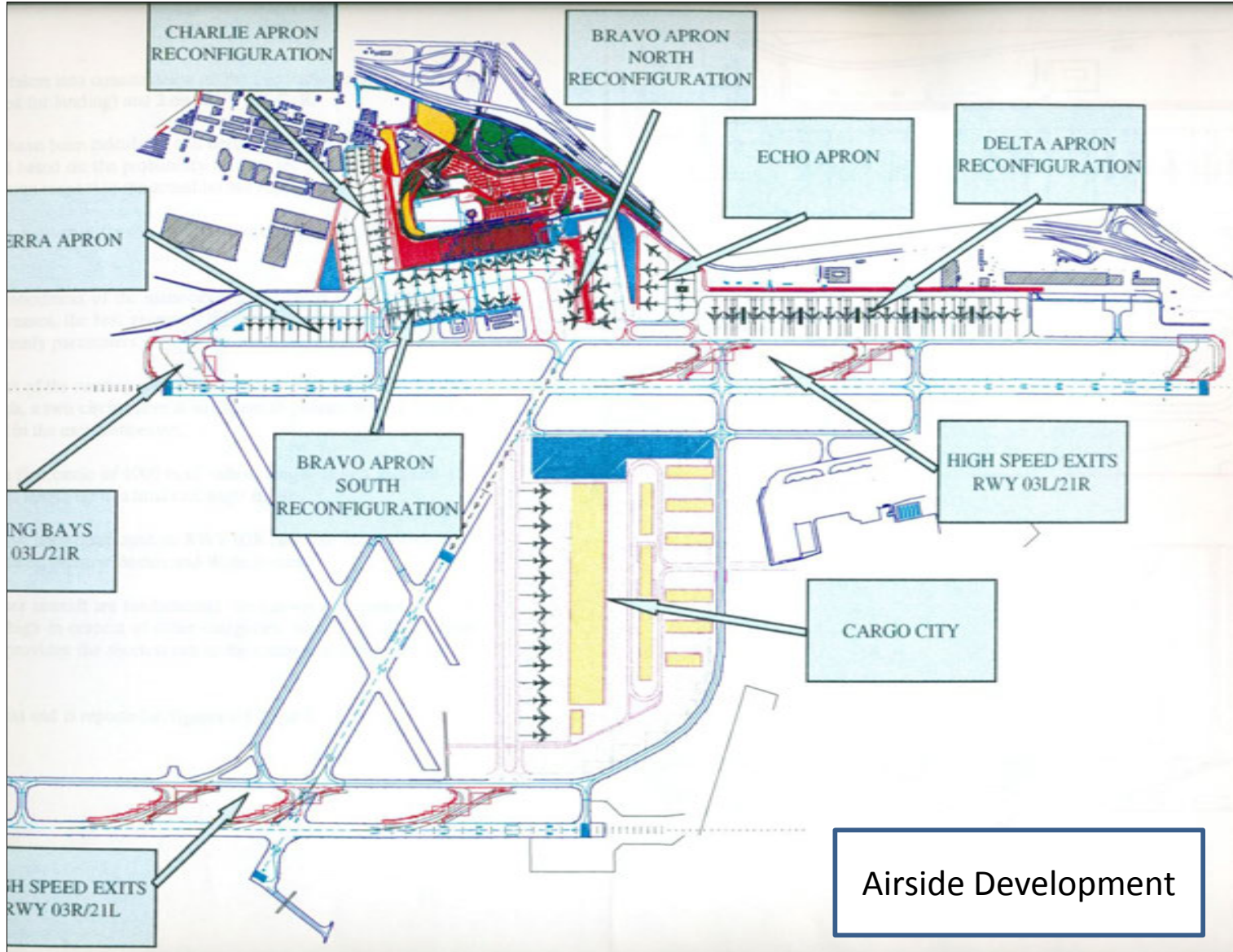

Cape Town International Airport

ACSA
AIRPORTS COMPANY SOUTH AFRICA



2015 Development Scenario





Cape Town International Airport

2030 Development Scenario

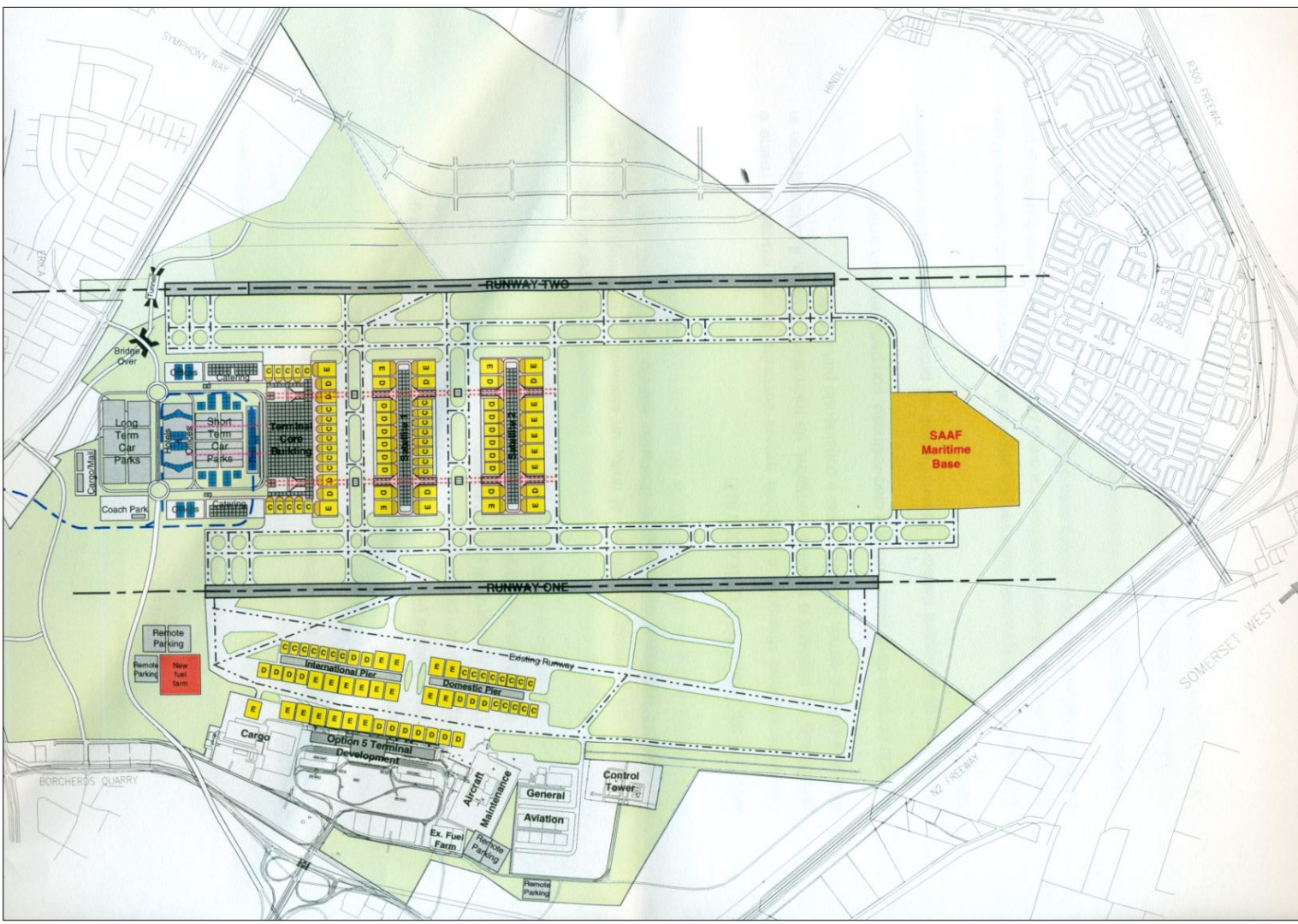

Basra Military Airport and Heliport



Basra Military Airport and Heliport

